





# Ellison

 2-Story Home  
 2,517 sq ft.

 4 Bedrooms  
 2.5 Bathrooms



ELEVATION A



ELEVATION B



ELEVATION C



ELEVATION C2



ELEVATION D



ELEVATION D2



ELEVATION D3



ELEVATION E

## CHOICES

We offer a variety of flexible floor plans and top-quality features at a price point you'll love.

## QUALITY

Our dedication to quality can be seen in our superior craftsmanship as we strive to be the best home builder in Omaha.

## SIMPLE

Our homebuilding and customer service processes are straightforward and dedicated to you.



## ENERGY-EFFICIENT

Trust The Home Company to build your energy-efficient home and enjoy peace-of-mind knowing that we have some of the lowest Home Energy Rating Service (HERS) scores in Omaha's history.



# Ellison

 2-Story Home  
 2,517 sq. ft.

 4 Bedrooms  
 2.5 Bathrooms

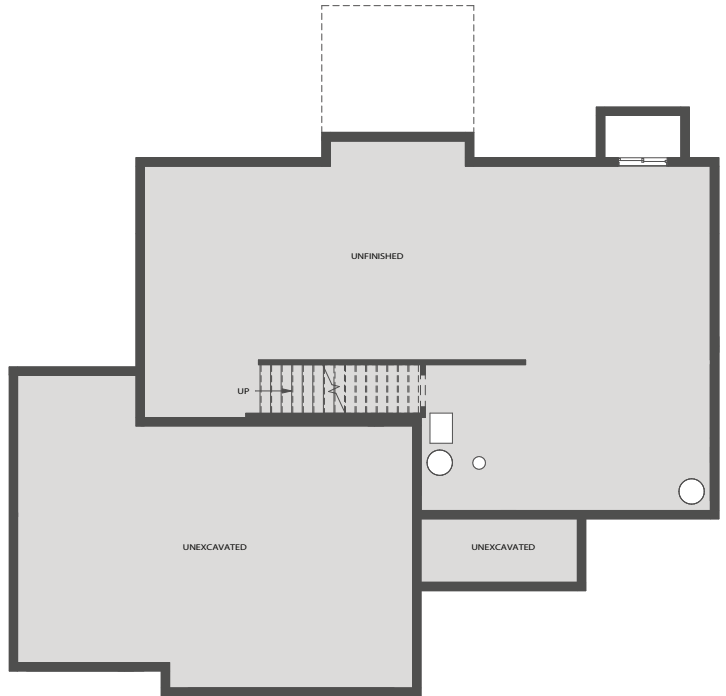

Artist rendering may vary from plan, prices, elevations and floorplans may be subject to change, see sales associate for details. 06/2025



THE HOME COMPANY

A HUBBELL AFFILIATE

VISIT OUR MODEL HOMES

Saturday and Sunday, 1-5pm

**The Edison**  
11132 N. 161st Ave.  
Bennington, NE 68007

**The Santa Clara**  
8205 S 196th St.  
Gretna, NE 68028

**The Ellison**  
11805 S. 110th Ave.  
Papillion, NE 68046

**The Paloma**  
20720 Kansas Ave.  
Elkhorn, NE 68022